

GV-FD220D 2MP H.264 Fixed IP Dome



- 1/2.5" progressive scan CMOS
 - Stream 1 from H.264 and MJPEG;
 - Stream 2 from H.264, MPEG4 and MJPEG
 - Up to 30 fps at 1920 x 1080
 - 3-axis mechanism (pan / tilt / roll)
 - Varifocal megapixel lens
 - Intelligent IR
 - 2-way audio
 - AAC and G.711 audio codec
 - One sensor input and alarm output
 - TV-out support
 - Micro SD/SDHC Card Slot
 - DC 12V / AC 24V / PoE
 - Motion detection
 - Tampering alarm
 - Privacy mask
 - Removable IR-cut filter for Day/Night function
 - IP address filtering
 - Supports iPhone, iPad, Android & 3GPP
 - 31 languages on Web interface
- * No SD/SDHC card slot & local storage function for Argentina.

Active Tampering Alarm

Tampered



Focus Change



Camera Shift



Hard-Ceiling Mount

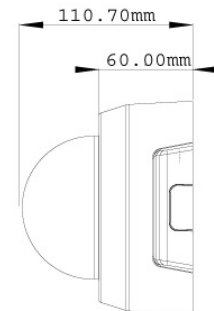
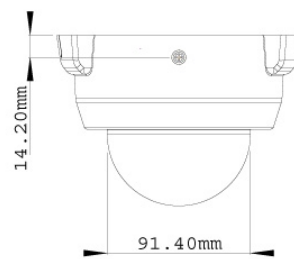
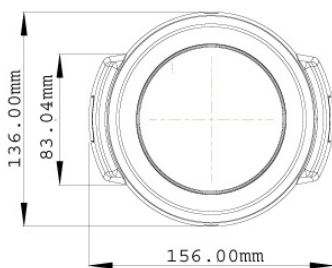

In-Ceiling Mount

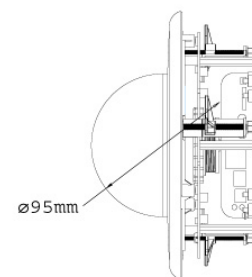
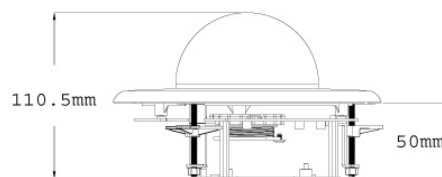
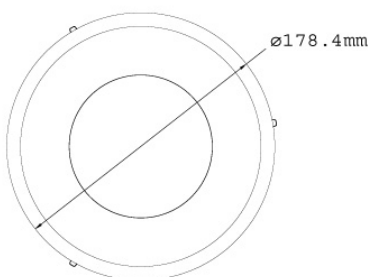

SPECIFICATIONS

Camera		
Image Sensor		1/2.5" progressive scan CMOS
Picture Elements		1920 (H) x 1080 (V)
Minimum Illumination	Color	1 Lux (1/30 sec), 0.5 Lux (1/5 sec)
	B/W IR ON	0 Lux
Shutter Speed		Automatic, Manual (1/5 ~ 1/8000 sec)
White Balance		Automatic, Manual (2800K ~ 8500K)
Lens		
Megapixel		Yes
Day/Night		Yes (with removable IR-cut filter)
Lens Type		Varifocal
Focal Length		2.7 ~ 9 mm
Maximum Aperture		F/1.3
Mount		Ø 14 mm
Image Format		1/3"
Operation	Focus	Manual (w / lock)
	Zoom	Manual (w / lock)
	Iris	DC
IR LED Quantity		15 IR LEDs
IR Distance		15 m / 50 ft (Max.)
Operation		
Video Compression		H.264, MPEG4, MJPEG
Video Streaming		Stream 1 from H.264 and MJPEG; Stream 2 from H.264, MPEG4 and MJPEG
Frame Rate		30 fps at 1920 x 1080 * The frame rate and the performance may vary depending on the number of connections and data bitrates (different scenes).
Image Setting		Brightness, Contrast, Sharpness, Gamma, White Balance, Flicker-less, Image Orientation, Shutter Speed, Backlight Compensation, D/N Sensitivity
Audio Compression		G.711, AAC (16 kHz / 16 bit) * AAC is only supported by GV-System V8.5 or later
Two-way Audio		Yes
Sensor Input		1 Input (Dry Contact)
Alarm Output		1 Output (200mA 5V DC)
Video Resolution		
Main Stream	4:3	1600 x 1200, 1280 x 960, 640 x 480, 320 x 240
	16:9	1920 x 1080, 1280 x 720, 640 x 360, 448 x 252
	5:4	1280 x 1024, 640 x 512, 320 x 256
Sub Stream	4:3	640 x 480, 320 x 240
	16:9	640 x 360, 448 x 252
	5:4	640 x 512, 320 x 256
Network		
Interface		10/100 Ethernet
Ethernet Protocol		HTTP, HTTPS, TCP, UDP, SMTP, FTP, DHCP, NTP, UPnP, DynDNS, 3GPP/ISMA, RTSP, PSIA, SNMP, QoS (DSCP)
Mechanical		
Lens Mounting		Ø 14 mm
Camera Angle Adjustment	Pan	0° ~ 350°
	Tilt	10° ~ 90°
	Rotation	0° ~ 340°
Temperature Detector		Yes

Connectors	Power	2-pin terminal block, PoE
	Ethernet	Ethernet (10/100 Base-T), RJ-45
	Audio	1 In (microphone phone jack, 3.5 mm / 0.14 in) 1 Out (Stereo phone jack, 3.5 mm / 0.14 in)
	Digital I/O	3-pin terminal block, pitch 2.5 mm / 0.1 in
	Auto Iris	DC drive
	Local Storage	Micro SD/SDHC memory card slot (for Class 6 card or above)
	TV-Out	BNC connector (640 x 480)

General		
Environment Temperature	0 °C ~ 50 °C / 32 °F ~ 122 °F	
Humidity	10% to 90% (no condensation)	
Power Source	12V DC / 24V AC / PoE	
Max. Power Consumption	12 W	
Dimensions	ø 156 x 110 mm / 6.14 x 4.33 in	
Weight	580 g / 1.28 lb	
Regulatory	CE, FCC, C-Tick, RoHS compliant	

Power over Ethernet		
PoE Standard	IEEE 802.3af Power over Ethernet / PSE	
PoE Power Supply Type	End-Span	
PoE Power Output	Per Port 48V DC, 350mA. Max. 15.4 watts	

Web Interface		
Installation Management	Web-based configuration	
Maintenance	Firmware upgrade through Web Browser or Utility	
Access from Web Browser	Camera live view, video recording, change video quality, bandwidth control, image snapshot, digital I/O control, audio, Wide Angle Lens Dewarping, Picture in Picture, Picture and Picture, Privacy Mask, Visual Automation, Tampering Alarm, Text Overlay	
Language	Arabic / Bulgarian / Czech / Danish / Dutch / English / Finnish / French / German / Greek / Hebrew / Hungarian / Indonesian / Italian / Japanese / Lithuanian / Norwegian / Persian / Polish / Portuguese / Romanian / Russian / Serbian / Simplified Chinese / Slovakian / Slovenian / Spanish / Swedish / Thai / Traditional Chinese / Turkish	

Applications		
Network Storage	GV-NVR, GV-System, GV-Backup Center, GV-Recording Server	
Mobile Phone support	GV-AView for Android Smartphone, GV-Eye HD for iPad, GV-Eye for iPhone and iPod Touch, GV-GView for Windows PDA, GV-MSView for Windows Smartphone, GV-SSView for Symbian Smartphone, 3G-enabled phone.	
Live Viewing	IE, GV-MultiView	
CMS Server support	GV-Control Center, GV-Center V2, GV-VSM	

Note:

1. Do not use clothes or any ordinary material to clean the camera cover since they may result in scratches.
2. Specifications are subject to change without notice.